

index

TAURO PLVD 80 is a hanging foldable system for glass doors of up to 80 kg, expandable, since it allows installing various solutions thanks to its Kit 2 Panels and Kit +2 Panels. When combining with the Kit Pivot Door VD, it is possible to incorporate a passage door.

21	General data and door sizing
21	Detail of parts and pieces
23	Installation possibilities
24	Step 1: Track installation and upper pieces
25	Step 2: Guide track installation and bottom pieces
26	Step 3: Clamp set-up
28	Step 4: Clamp installation on door n°1
29	Step 5: Clamp set-up and Fascia key deadbolt to door n°2
30	Step 6: Bracket aligner set-up and door aligner
31	Step 7: Door assembly
32	Step 8: Hinge set-up
33	Step 9: Fascia and cap set-up
34	Step 10: Door adjustment
35	Other configurations
37	Notes

***ALL MEASUREMENTS ARE EXPRESSED IN MILLIMETERS**

General data and door sizing



MAX DOOR
WEIGHT



MAX WEIGHT IN
STACKING AREA



DOOR
THICKNESS

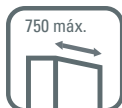

DOOR
WIDTH



PEOPLE NEEDED
FOR INSTALLATION

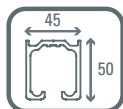

TRACK U 150
SMOOTH

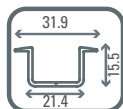

GUIDE TRACK
PL



FASCIA KIT 2P / +2P
TAURO PLVD 80



FASCIA KIT FOLDING
DOOR VD

Door sizing

| 2 doors |

$$DW = (OW - 18) / 2$$

$$DH = OH - 68$$

$$H1 = GH - 168$$

$$DW \leq 750$$

| 4 doors |

$$DW = (OW - 24) / 4$$

$$DH = OH - 68$$

$$H1 = GH - 168$$

$$DW \leq 750$$

- For other configurations, go to page 34

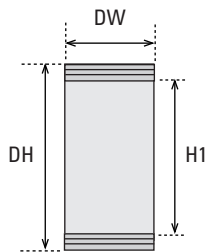
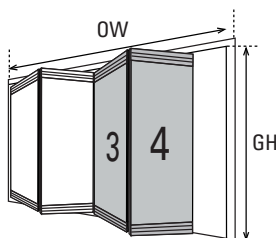
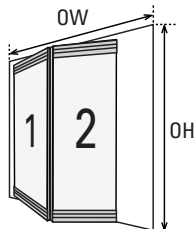

DW = Door Width | OW = Opening Width | DH = Door Height | GH = Glass Height | OH = Opening Height

NOTE: the formulas for the glass measurement calculation do not include the use of any type of gasket at the edge of the glass. If they are used, an adjustment must be made to the measurement, depending on the chosen gasket.

Detail of parts and pieces

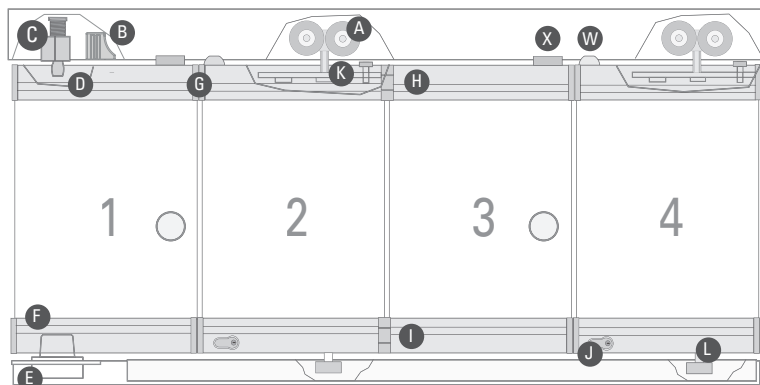

		Kit 2 Panels	Kit +2 Panels
A	Carrier set Tauro PLVD 80	1	1
B	Bump track	1	
C	Upper pivot set	1	
D	Pivot clamp	1	
E	Door jamb	1	
F	Door jamb clamp	2	4
G	PLVD Hinges	3	4
H	Upper clamps	3	4
I	Lower clamps	1	1
J	Key deadbolt cylinder	2	2
K	Carrier plates (25 and 28 mm)	1	1
L	Guide plates 25 mm	1	1
M	Key deadbolt centralizer track PL	1	1
N	Key deadbolt mechanism	2	2
O	Key deadbolt spacer		

		Kit 2 Panels	Kit +2 Panels
O	Left end cap	4	
P	Left cap	2	4
Q	Right cap	6	4
R	Hub VD	16	16
S	Adhesive	8	8
T	Spacer 164mm	2	3
U	Spacer 43mm	2	2
V	Door aligner PLVD	1	1
W	Bracket aligner PLVD	1	1
X	Segmenta key	1	1
Y	Segmenta key 01	1	
Z	Allen key 3mm	1	1
A'	Allen key 4mm	1	1
B'	Bolts M5 x 20	36	34

*Fascia Kit 2P / +2P Tauro PLVD 80 sold separately. 1 Kit used for 2 Panels.

Installation possibilities

FOLDABLE TOWARDS THE INTERIOR OF THE OPENING

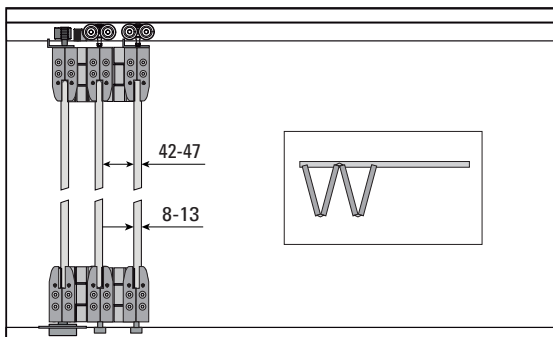

FOLDABLE TOWARDS THE EXTERIOR OF THE OPENING

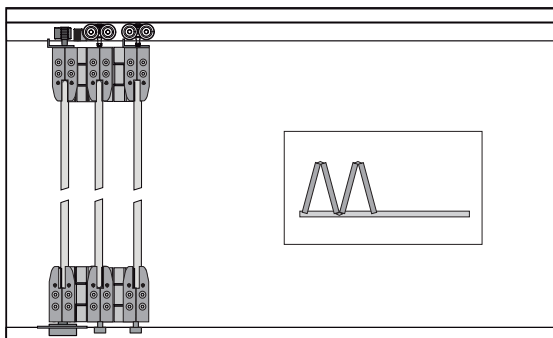

The system can also be folded towards the right or left of the opening.

*For 2 door application, (lower) PL Guide track no needed.

step 1

- 



-

-

-
- A horizontal beam of length l is shown. A uniformly distributed load q acts downwards along the entire length of the beam. The beam is supported by a roller support at the right end. The coordinate x starts at the left end and increases to the right. The total load is indicated as $Q = q \cdot l$.

Guide track installation and bottom pieces

step 2

- Plumb pivot to align the door jamb (drawing A).
- Drill a $\varnothing 35$ mm hole in the ground for the door jamb (drawing B).
- Set up on the floor for the guide track (drawing C).
- Install the door jamb (drawing D).

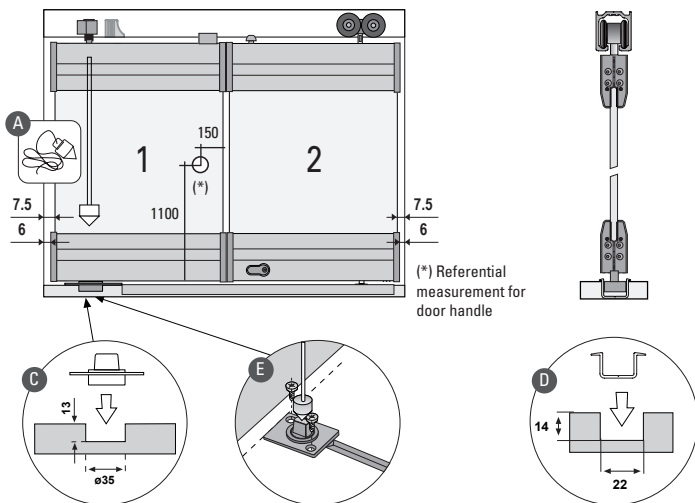

- Fix the guide track to the floor. If mounting 2 foldable panels, not necessary.

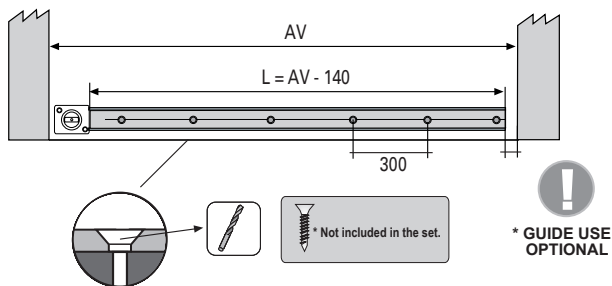

Clamp set-up

step 3

OPTION 1: Drilled clamp set-up, with mechanized glass

- * Recommended option for glass over 50 kg.
- * Not required for the operation of the system.
- * Tempered glass usage recommended.
- * Consider door handle drilling.
- * The installation of the plastic hubs and the assembly of the clamps apply for each one of the pressure clamps of the system.

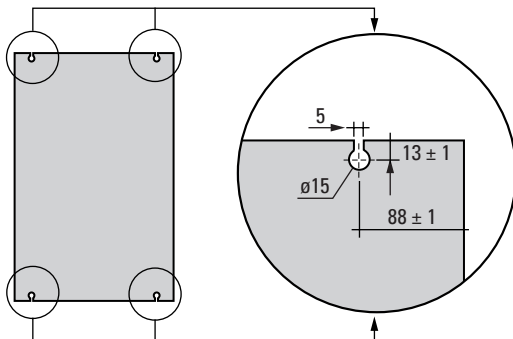

- Place the clamp on the crystal 6mm from the edge and place the hub on the crystal, according with the width.

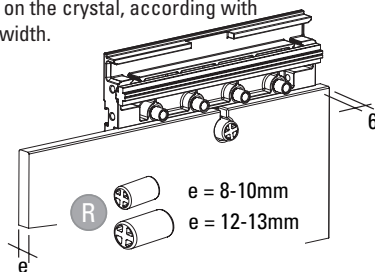

- Place the other part of the clamp and the bolts. Then, tighten with 4mm Allen key.

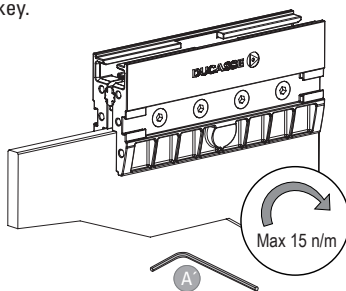

OPTION 2: Compression clamp set-up

- Assemble the clamps according with the drawing, making sure to place the spacer in their correct position, according with the thickness of the glass being used.

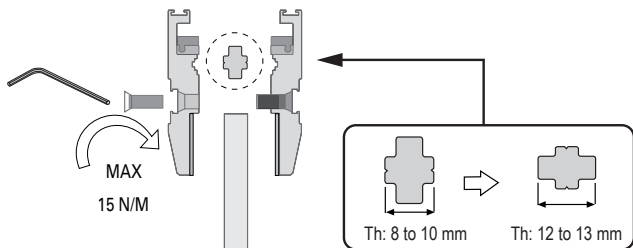

CLAMP WITH KEY DEADBOLT > assemble using the correct components.

- For 8-10mm glasses, use: 25mm plates, spacer in position 8-10 and 2 key deadbolt spacers.
- For 12-13mm glasses, use: 28mm plates, spacers in position 12-13 and 1 key deadbolt spacer.

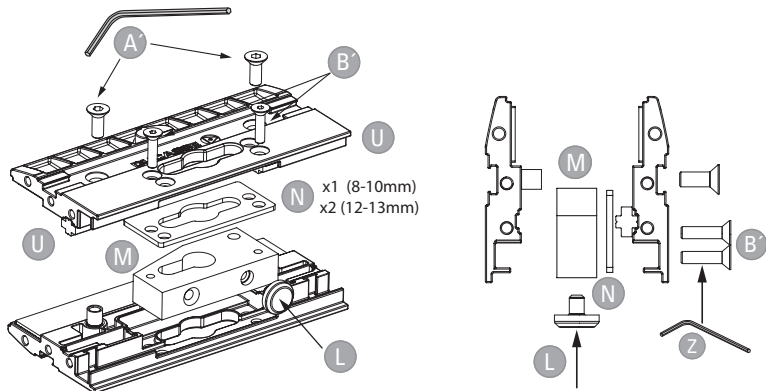

Clamp set-up on door n°1

step 4

- Mount the clamps 6mm from the edge of the glass.
- The clamps must be left in the position indicated in the drawing, ending with the stopper on the left.

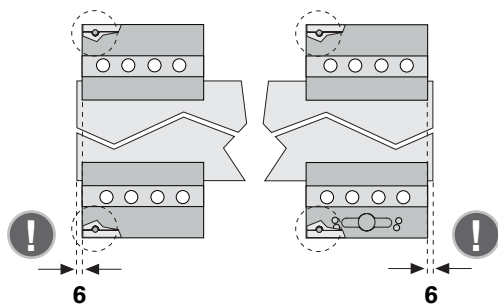

- Adjust the plate bolts with the Segmenta key.
- Adjust the clamp bolts with the 4mm Allen key, applying 15 NM until the glass is held firm.

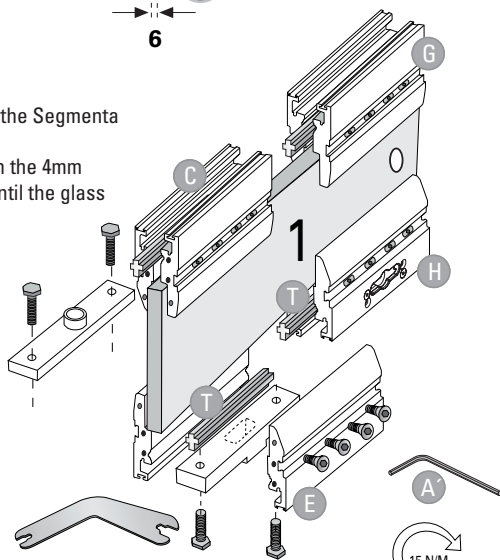

Clamp set-up and Fascia key deadbolt on door n°2

step 5

- Mount the clamps in the same way as on door n°1.
- Use 43mm spacers for the clamp where the key deadbolt will be at.

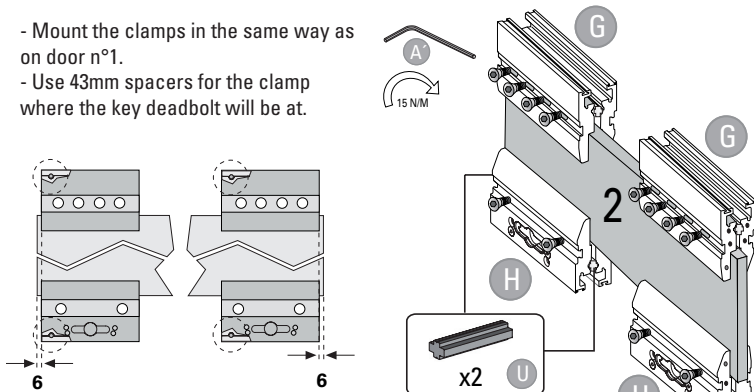

- Stick adhesives on the ends of the lower clamps as shown in drawing. Then, fix the Fascia (Fascia Kit 2P / +2P Tauro PLVD 80 – not included in the kit).

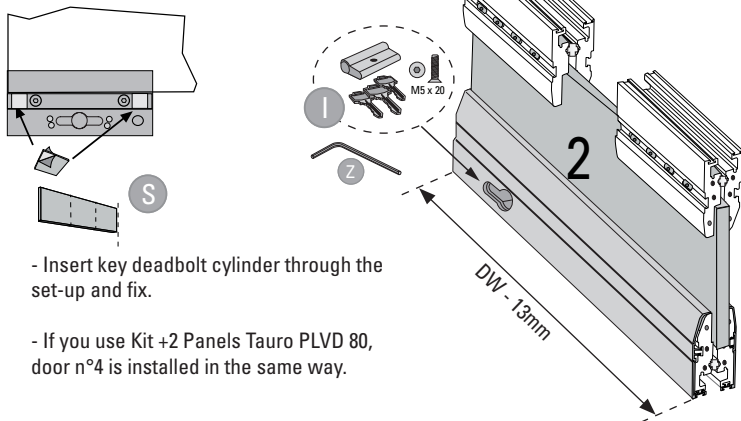

- Insert key deadbolt cylinder through the set-up and fix.
- If you use Kit +2 Panels Tauro PLVD 80, door n°4 is installed in the same way.

Bracket aligner and door aligner set-up

step 6

- Insert bracket aligner PLVD in the clamps of door n°1 and n°3 (in case of using Kit 2+ Tauro Panels PLVD 80). Fix with 3mm Allen key.
- Mount door aligner PLVD in the clamps of door n°2 / n°4 and fix with 3mm Allen key.

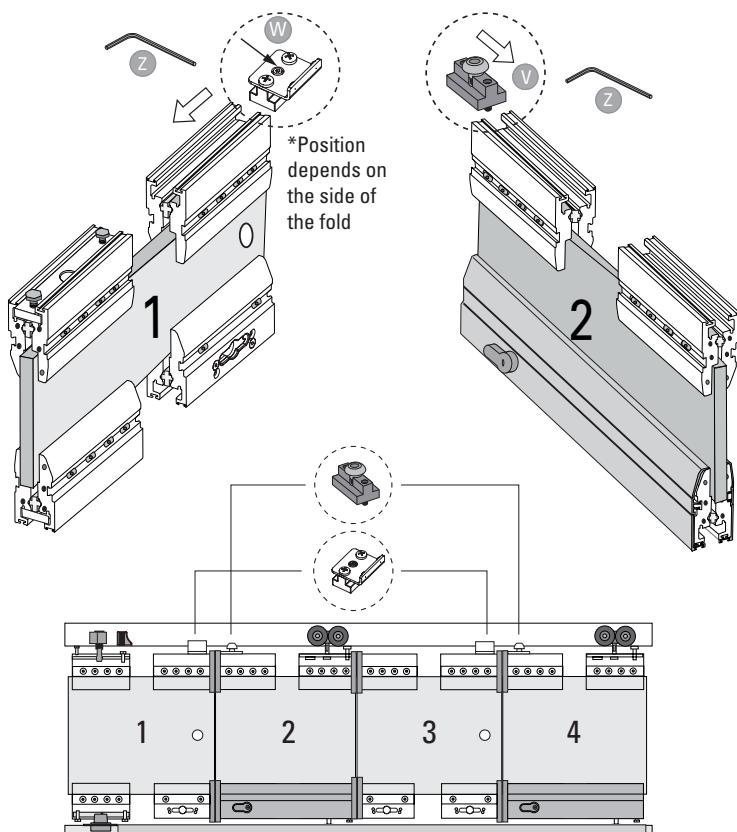

- Verify that the pivot is screwed and all the way to the end in the track.
- Assemble door n°1 on the door jamb.
- Align the top part and lower the pivot to the limit with the Segmenta key.

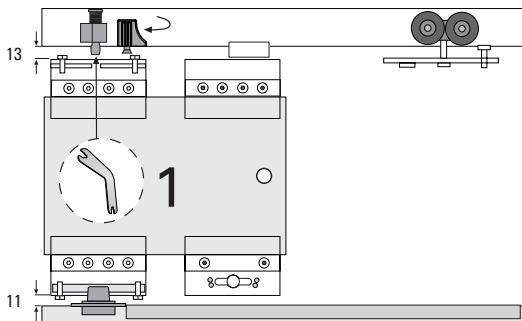

- Insert the carrier plate in door n°2, attaching the plate with the clamp and then fixing it with Segmenta key 01.
- Insert the guide plate in the lower clamp and fix with Segmenta key 01.

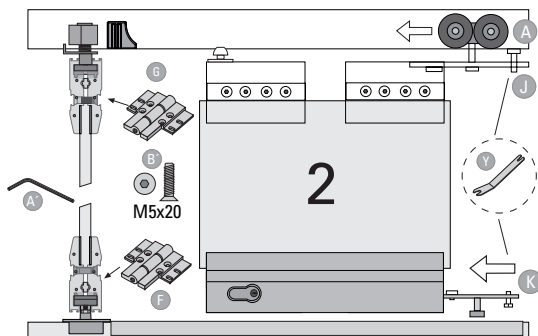

Hinge set-up

step 8

- Fix upper and lower hinge to the clamps of door n°1 with bolts M5x20 and 3mm Allen key.

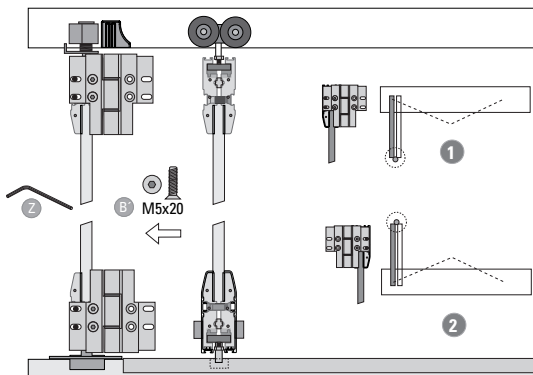

- If you use the Kit 2+ Panels Tauro PLVD 80, the set-up of the hinges and the mounting of the doors n°3 and n°4 must be done in the same way.

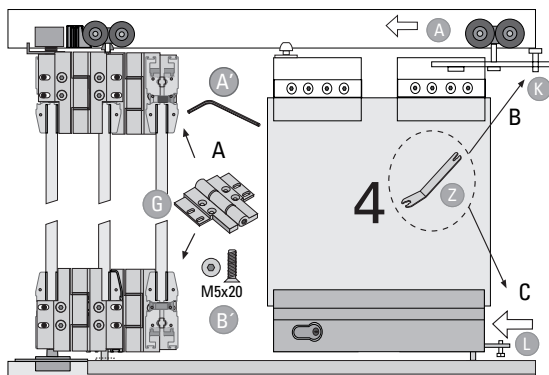

- Stick the adhesive on the ends of the clamps and mount the Fascias.

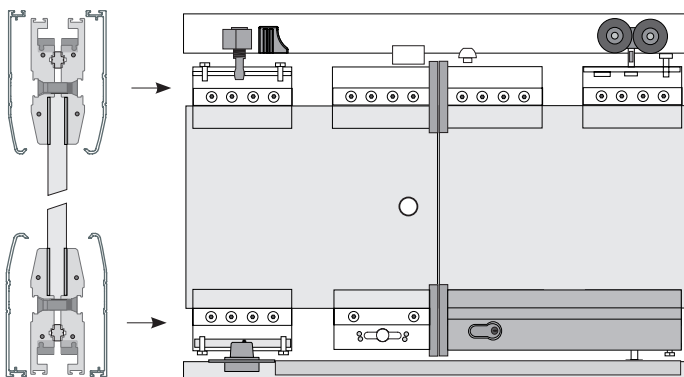

- Once the Fascias of all the doors have been mounted, fix the end caps with bolts M5x20 and 3mm Allen key, for an excellent termination.

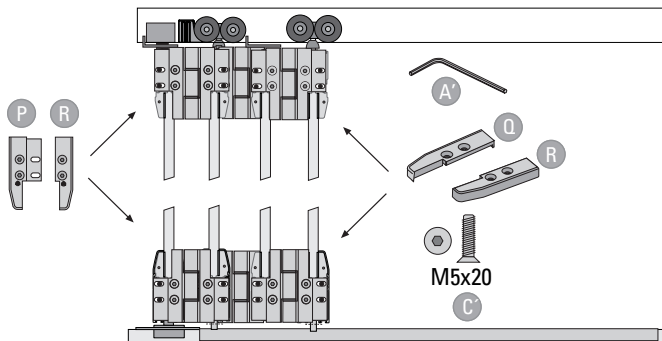

Door adjustment

step 10

- Adjust the door aligner PLVD with 3mm Allen key.
- Adjust the height of the doors, aligning them with each other.
- Once they have been adjusted, counter-turn at the carrier and the guide with Segmenta key.
- The gap shown in the drawing must be considered:
 - > Gap between the upper track and door: 10mm.
 - > Gap between the lower track and door: 8mm.
 - > Gap between doors: 3mm.
 - > Gap between door and opening: 7.5mm.
 - > Gap between cap and opening: 6mm.

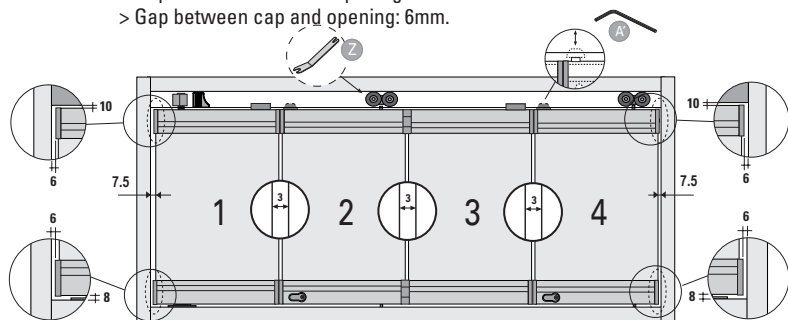

Views of the system installed, closed and open.

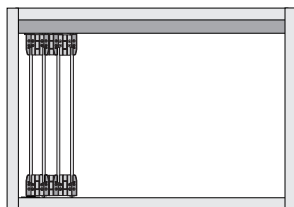
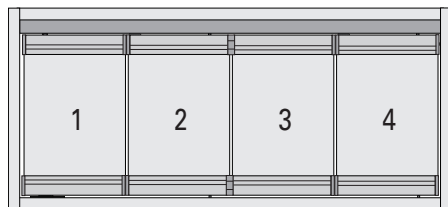

Other configurations

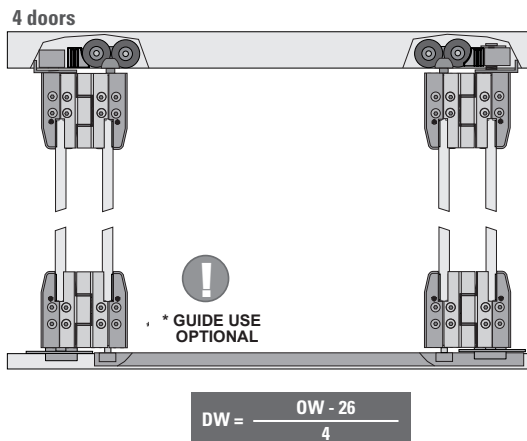
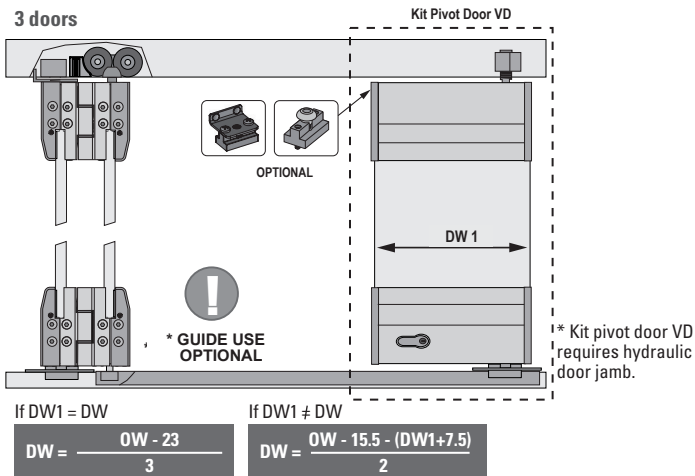

Other configurations

5 doors

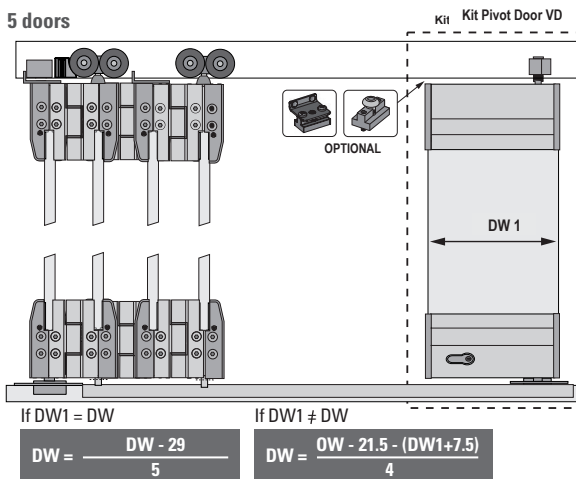

* Kit pivot door VD requires hydraulic door jamb.

8 doors

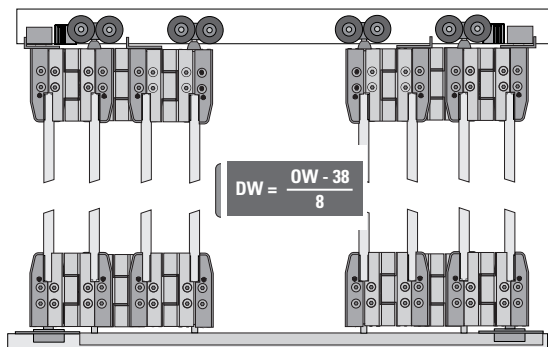

NOTE: the formulas for the glass measurement calculation do not include the use of any type of gasket at the edge of the glass. If they are used, an adjustment must be made to the measurement, depending on the chosen gasket.